



ISO GRIPS FOR INDIAN

6366

THANK YOU FOR CHOOSING KÜRYAKYN!

PROTECT YOURSELF AND OTHERS FROM POSSIBLE INJURY AND PROPERTY DAMAGE OR LOSS. PAY CLOSE ATTENTION TO ALL INSTRUCTIONS, WARNINGS, CAUTIONS, AND NOTICES REGARDING THE INSTALLATION, USE, AND CARE OF THIS PRODUCT.

WARNING	THIS INDICATION ALERTS YOU TO THE FACT THAT IGNORING THE CONTENTS DESCRIBED HEREIN CAN RESULT IN POTENTIAL DEATH OR SERIOUS INJURY.
CAUTION	This indication alerts you to the fact that ignoring the contents described herein can result in minor or moderate potential injury.
NOTICE	This indication alerts you to the fact that ignoring the contents described herein may negatively affect product performance and functionality or damage the product itself or the product to which it is being attached.

MAKE SURE THE FOLLOWING PARTS HAVE BEEN INCLUDED IN THE KIT:

- 1 Right Side Grip
- 1 Left Side Grip
- 1 Adhesive
- 1 Installation Instructions

TOOLS SUGGESTED:

Set of Torx drivers, Phillips head screwdriver

NOTICE These installation instructions contain important information. Ensure that the end user receives this copy and is aware of its importance for future reference.

STEP 1 Read and understand all steps in the instructions before starting the installation. Park the motorcycle on a hard, level surface and turn off the ignition. Remove the main fuse.

WARNING THE END USER'S SAFETY DEPENDS UPON PROPER INSTALLATION OF THIS PRODUCT. IF A STEP IN THIS SET OF INSTRUCTIONS IS NOT WITHIN YOUR CAPABILITIES OR YOU DO NOT HAVE THE CORRECT TOOLS, HAVE YOUR DEALER PERFORM THE PROCEDURE. IMPROPER INSTALLATION OF THIS PRODUCT COULD RESULT IN DEATH OR SERIOUS INJURY.

WARNING ACCIDENTAL VEHICLE START-UP COULD CAUSE DEATH OR SERIOUS INJURY, REMOVE THE MAIN FUSE BEFORE PROCEEDING.

CUSTOMER SERVICE
877.370.3604 (toll free)

INSTALLATION QUESTIONS
techsupport@kuryakyn.com
or call 715.247.2983

LIMITED WARRANTY

Kuryakyn warrants that any Kuryakyn products sold hereunder, shall be free of defects in materials and workmanship for a period of one (1) year from the date of purchase by the consumer excepting the following provisions:

- Kuryakyn shall have no obligation in the event the customer is unable to provide a receipt showing the date the customer purchased the product(s).
 - The product must be properly installed, maintained and operated under normal conditions.
 - Kuryakyn makes no warranty, expressed or implied, with respect to any gold plated products.
 - Kuryakyn shall not be liable for any consequential and incidental damages, including labor and paint, resulting from failure of a Kuryakyn product, failure to deliver, delay in delivery, delivery in nonconforming condition, or for any breach of contract or duty between Kuryakyn and a customer.
- Kuryakyn products are often intended for use in specific applications. Kuryakyn makes no warranty if a Kuryakyn product is used in applications other than intended.
- Kuryakyn electrical products are warranted for one (1) year from the date of purchase by the consumer. L.E.D.'S contained in components of Kuryakyn products will be warranted for defects in materials and workmanship for 3 years from the date of purchase where as all other components shall be warranted for one(1) year. This includes, but is not limited to; control modules, wiring, chrome & other components.

- Kuryakyn makes no warranty of any kind in regard to other manufacturer's products distributed by Kuryakyn. Kuryakyn will pass on all warranties made by the manufacturer and where possible, will expedite the claim on behalf of the customer, but ultimately, responsibility for disposition of the warranty claim lies with the manufacturer.

ABOUT OUR CATALOG

For purchasing Kuryakyn® products, you can receive a complete catalog free of charge. Send the Proof-of-Purchase below with your address to: Kuryakyn
454 County Road V V
Somerset, WI 54025-9031
Please indicate either Accessories Catalog for Harley-Davidson® or GL & Metric Cruisers.

Be sure to ask your local dealer about other Kuryakyn® products, the motorcycle parts and accessories designed for riders by riders.

©2005 Kuryakyn USA® All Rights reserved.



THROTTLE SIDE PROCEDURE:

- STEP 2** Remove the two screws securing the brake lever/master cylinder assembly to the handlebars; use a zip tie to temporarily secure the assembly to the handlebars. Ensure that brake fluid does not leak from the master cylinder and drip onto painted surfaces.
- STEP 3** Refer to **PIC 1**. Remove the four Torx screws and separate the throttle-side switch housing.
- STEP 4** Note how the plastic throttle sleeve fits into the channel in the switch housing. Carefully slide the existing grip off of the handlebar.
- STEP 5** Refer to **PIC 2**. Slide the new ISO Grip into place on the handlebar. Rotate the Grip on the bar until it aligns with the switch housing, then slide it into place.
- STEP 6** Refer to **PIC 3**. Align the pin in the rear half of the switch housing with the hole in the handlebar; reassemble the switch housing and secure with the four Torx screws.
- STEP 7** Reassemble the brake lever/master cylinder assembly onto the handlebar.

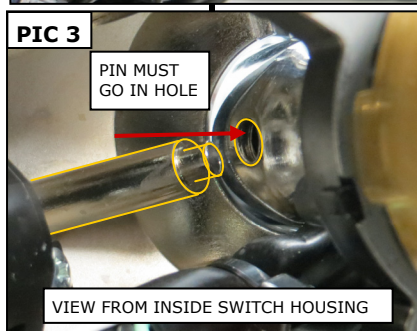
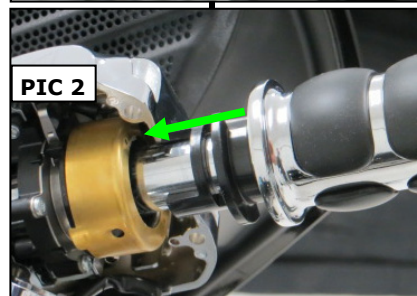
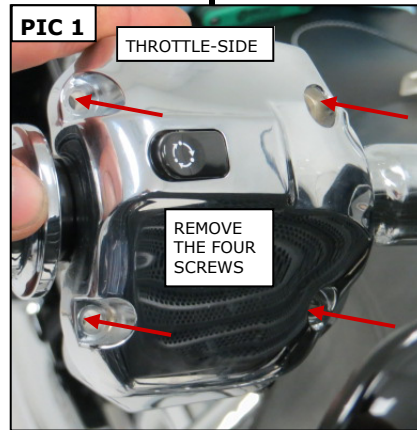

CLUTCH SIDE PROCEDURE:

- STEP 8** Peel back on the grip as shown in **PIC 4**; remove the screw, set it aside it will not be reused. Remove the clutch-side grip from the handlebar. The grip may also be glued to the handlebar; you may need to twist the grip to break the adhesive bond.
- STEP 9** Prepare the clutch-side handlebar for proper adhesion by sanding the surface with 80-100 grit sandpaper or emery cloth. Remove any glue residue from the handlebar.
- STEP 10** With an ammonia based cleaner (Windex) and a clean rag, remove any contaminants from the handlebar and the inside of the grip.

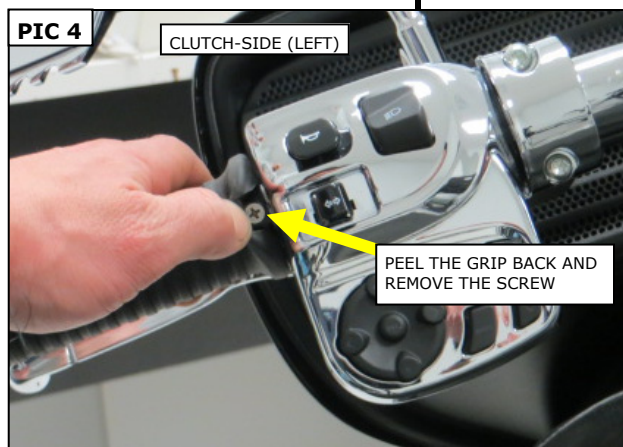

NOTE: Determine the desired orientation of the clutch-side ISO grip BEFORE gluing and installing.

The supplied adhesive sets up **ALMOST INSTANTLY** in the absence of air. There is enough time to slide the grip into place, but **ONCE IT STOPS MOVING, IT CANNOT BE ADJUSTED.**



Avoid contact with eyes, skin and clothing. Avoid breathing vapors or mists of this product. Wash thoroughly after handling. Avoid contact with fabric or paper goods. Contact with these materials may cause rapid polymerization which can generate smoke and strong irritating vapors, and cause thermal burns.

- STEP 11** Test fit the ISO grip on the handlebar; determine the orientation of the grip before gluing it to the handlebar.
- STEP 12** Open the supplied tube of adhesive and squeeze all of the glue onto the inner side walls of the clutch-side grip. Rotating the grip while applying the glue will help distribute it evenly. Make sure you get the glue all the way to the end of the rubber insert in the grip.
- STEP 13** In one smooth motion, slide the grip onto the handlebar and into position. Rotate it back and forth slightly as you slide it on to help distribute the glue evenly and keep the grip from “plowing” the glue up against the switch housing. **You must work quickly to get the desired position before the glue dries. (Approx. 6 seconds).**
- STEP 14** Once in place, squeeze the grip firmly to press the rubber against the bar and hold for 15 seconds. Allow at least 30 minutes to cure before operating the motorcycle.
- STEP 15** Reinstall the main fuse. **Ensure proper throttle and brake function BEFORE operating the motorcycle.**

NOTICE

It is the end user’s responsibility to ensure that all of the fasteners (including pre-assembled) are tightened before operation of the motorcycle. Küryakyn will not provide warranty coverage on products or components lost due to improper installation or lack of maintenance. Periodic inspection and maintenance are required on all fasteners.

Ride On!