



## L.E.D. LAMPS for KURYAKYN 5000 SERIES LIGHTS

## 5035

### PARTS INCLUDED

- 2 L.E.D. Lamps for Kuryakyn 5000 Series Lights
- 1 Installation Instructions

Please read and understand entire instructions before starting installation.

### THANK YOU FOR CHOOSING KÜRYAKYN!

**IN ORDER TO PROTECT YOU AND OTHERS FROM POSSIBLE INJURY AND/OR PROPERTY DAMAGE OR LOSS, PLEASE PAY CLOSE ATTENTION TO ALL INSTRUCTIONS, WARNINGS, CAUTIONS AND NOTICES REGARDING THE USE AND CARE OF THIS PRODUCT.**

<b>WARNING</b>	<b>THIS INDICATION ALERTS YOU TO THE FACT THAT IGNORING THE CONTENTS DESCRIBED HEREIN CAN RESULT IN POTENTIAL DEATH OR SERIOUS INJURY.</b>
<b>NOTICE</b>	<b>This indication alerts you to the fact that ignoring the contents described herein may negatively affect product performance and functionality.</b>
<b>CAUTION</b>	<b>This indication alerts you to the fact that ignoring the contents described herein can result in potential injury or material damage.</b>

**NOTICE** IF INSTALLING THIS PRODUCT FOR ANOTHER PARTY, PLEASE MAKE SURE THEY RECEIVE THIS COPY OF THE INSTALLATION INSTRUCTIONS SO THEY ARE AWARE OF THE IMPORTANT INFORMATION CONTAINED IN THEM.

### TOOLS SUGGESTED

Set of Hex Wrenches

**STRICTLY OBSERVE THE FOLLOWING GUIDELINES IN ORDER TO USE THE PRODUCT PROPERLY AND AVOID POTENTIALLY DANGEROUS ACCIDENTS.**

**STEP 1** Read and understand all steps in the instructions before starting the installation. Park the motorcycle on a hard, level surface and turn off the ignition.

**CAUTION** Avoid potential electrical shock! Disconnect the battery before starting this procedure.

**NOTICE** Avoid damage to the motorcycle. Protect painted surfaces with a soft cloth or blanket.

**STEP 2** Disconnect the battery.

**STEP 3** As shown in PIC 1, remove the button socket cap screw located at the bottom of the light housing.

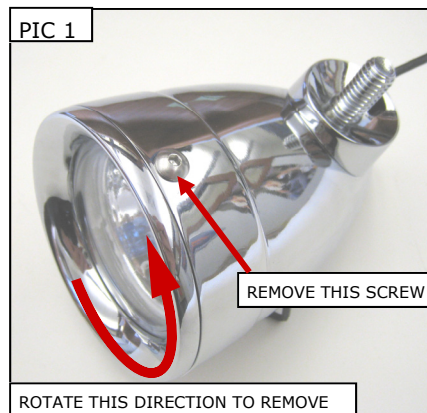

### CUSTOMER SERVICE

877.370.3604 (toll free)

### INSTALLATION QUESTIONS

techsupport@kuryakyn.com  
or call 715.247.2983

### LIMITED WARRANTY

Kuryakyn warrants that any Kuryakyn products sold hereunder, shall be free of defects in materials and workmanship for a period of one (1) year from the date of purchase by the consumer excepting the following provisions:

- Kuryakyn shall have no obligation in the event the customer is unable to provide a receipt showing the date the customer purchased the product(s).
  - The product must be properly installed, maintained and operated under normal conditions.
  - Kuryakyn makes no warranty, expressed or implied, with respect to any gold plated products.
  - Kuryakyn shall not be liable for any consequential and incidental damages, including labor and paint, resulting from failure of a Kuryakyn product, failure to deliver, delay in delivery, delivery in nonconforming condition, or for any breach of contract or duty between Kuryakyn and a customer.
- Kuryakyn products are often intended for use in specific applications. Kuryakyn makes no warranty if a Kuryakyn product is used in applications other than intended.
- Kuryakyn electrical products are warranted for one (1) year from the date of purchase by the consumer. L.E.D.'S contained in components of Kuryakyn products will be warranted for defects in materials and workmanship for 3 years from the date of purchase where as all other components shall be warranted for one(1) year. This includes, but is not limited to; control modules, wiring, chrome & other components.
- Kuryakyn makes no warranty of any kind in regard to other manufacturer's products distributed by Kuryakyn. Kuryakyn will pass on all warranties made by the manufacturer and where possible, will expedite the claim on behalf of the customer, but ultimately, responsibility for disposition of the warranty claim lies with the manufacturer.

### ABOUT OUR CATALOG

For purchasing Kuryakyn® products, you can receive a complete catalog free of charge. Send the Proof-of-Purchase below with your address to: Kuryakyn, P.O. Box 339, Somerset, WI 54025. Please indicate either Accessories Catalog for Harley-Davidson® or GL & Metric Cruisers.

Be sure to ask your local dealer about other Kuryakyn® products, the motorcycle parts and accessories designed for riders by riders.

©2005 Kuryakyn USA® All Rights reserved.



kuryakyn.com

**STEP 4** Remove the light bezel by twisting the bezel counter clockwise and pulling the bezel outward. PIC 1

**NOTE:** PIC 2 is an exploded view for reference.

**STEP 5** Remove the rubber inner seal from the chrome light housing. The glass light housing should now be free.

**STEP 6** Pull the glass housing out away from the chrome housing and disconnect the wires PIC 3.

**STEP 7** Remove the locating ring from the back of the glass light housing and place it on the back of one of the new L.E.D. Lamps in the same orientation. PIC 4 The notch on the locating ring goes on the bottom of the light and will line up with a post on the bottom of the housing. PIC 5

**NOTE:** Please note the orientation of the locating ring. This will greatly help when reassembling the lights. PIC 4 and PIC 5

**STEP 8** With the locating ring installed, connect the white wire from the new L.E.D. Lamp to the white wire inside the lamp. Connect the black wire from the new L.E.D. Lamp to the black wire inside the housing. **Make sure the metal portion of both connectors are fully inside the plastic insulating sleeve.**

**STEP 9** Place the new L.E.D. Lamp with the locating ring installed, into the light housing. Place the rubber gasket into the chrome bezel (there is a cutout on the rubber gasket that fits around the screw boss on the bezel PIC 6).

**STEP 10** Line up the posts on the bezel with the notches on the housing and place the bezel over the light and onto the housing. PIC 7 Turn the bezel clockwise to lock it on and line up the threads in the bottom hole on the bezel. PIC 8

**STEP 11** Insert the button head fastener removed in Step 3 and tighten securely. PIC 8

**STEP 12** Repeat Steps 3 through 11 for the other light.

**STEP 13** Reconnect the battery, turn the motorcycle on and test the lights.

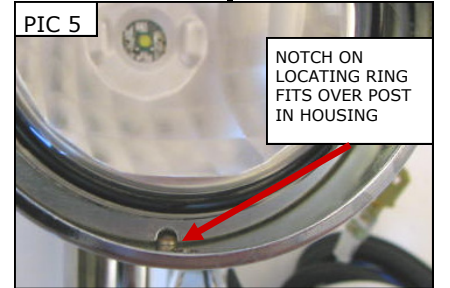
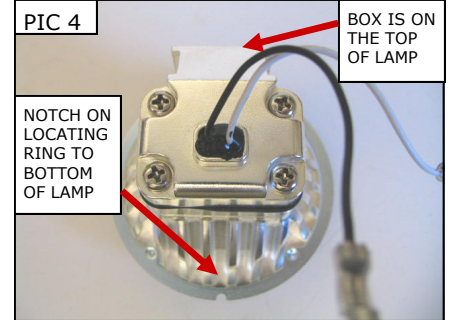
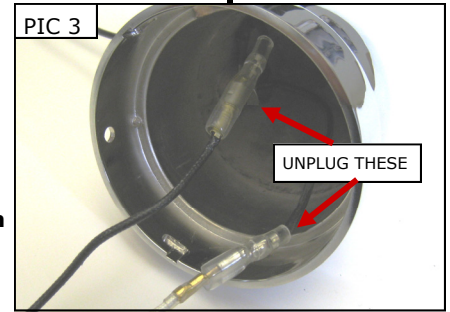

**WARNING** ENSURE PROPER LIGHT OPERATION BEFORE RIDING THE MOTORCYCLE. VISIBILITY IS A MAJOR CONCERN FOR MOTORCYCLISTS. A LIGHT MALFUNCTION COULD RESULT IN DEATH OR SERIOUS INJURY.

**NOTICE** It is the installer's responsibility to ensure that all of the fasteners (including preassembled) are tightened before operation of the motorcycle. Küryakyn will not warranty components lost due to improper installation. Periodic maintenance may be required.

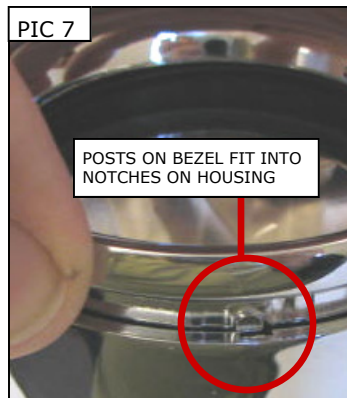
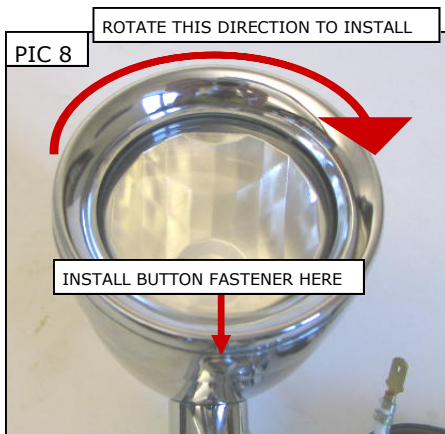
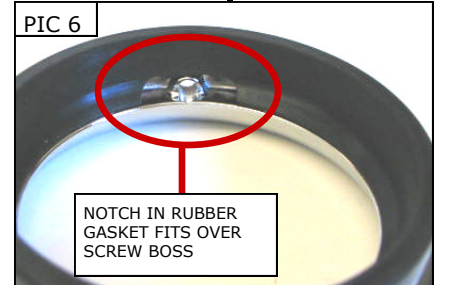

*Ride On!*